



ResoCradle

Product Information & Technical Data Sheet

Resonate's ResoCradle are made from ultra high density 100% recycled rubber crumb. This adaptable system allows for fast and accurate on-site floor levelling without the need for wet trades. ResoCradle's accept a variety of timber batten sizes, enabling a wide range of finished floor heights.

Sustainable Floor Levelling

This environmentally friendly alternative is ideal for new build and refurbishment applications, be it residential, commercial or sports floors.

They can also easily incorporate underfloor heating systems and services with the cradle zone and can be over laid with high strength thermally conductive flooring such as

[GYPDECK Structural](#).

Key Benefits



Excellent impact sound reduction

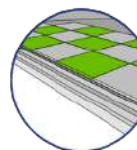
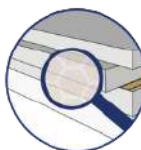

System can be levelled to an SR1 classification



Dry and lightweight system reduces build times.



System Components



2mm
Cradle Packers



5mm
Cradle Packers



20mm base
Acoustic Cradle.
Available with
40mm or 25mm
leg



10mm Cradle
Base Packer



30mm Cradle
Base Packer

Impact Noise Improvement
28dB (ΔL_w)

Robust Detail Compliant

E-FC-1 (FFT 2)

E-FC-2 (FFT 2)

E-FS-1 (FFT 2)

Product Applications and Typical Acoustic Performances



Concrete In-situ Floor CIS



1. Ceramic Tiles / Timber flooring / Carpet / Vinyl
2. Adhesive or decoupling layer
3. Resonate GYPDECK Structural floor panel
4. ResoThermEdge flanking strip
5. ResoCradle's and timber battens
6. 200mm Reinforced in-situ concrete slab
7. MF Ceiling (min 100mm void)
8. 1 x 9.5mm acoustic plasterboard

Airborne Sound Performance DnT,w + Ctr	54dB
Impact Sound Performance LnT,W	48dB
Impact Noise Improvement ΔLw	28dB



Concrete In-situ Floor CIS

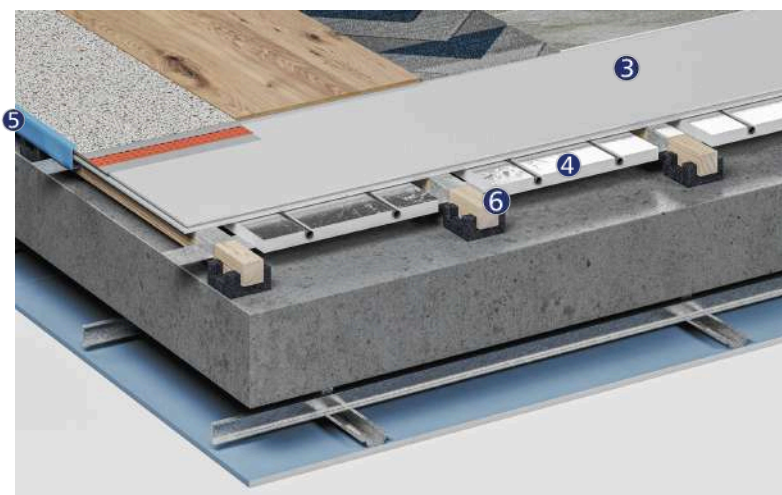

1. Ceramic Tiles / Timber flooring / Carpet / Vinyl
2. Adhesive or decoupling layer
3. Resonate GYPDECK Structural floor panel
4. UFH pipes laid in ResoThermXPS insulation
5. ResoThermEdge flanking strip
6. ResoCradle's and timber battens
7. 200mm Reinforced in-situ concrete slab
8. MF Ceiling (min 100mm void)
9. 1 x 9.5mm acoustic plasterboard

Airborne Sound Performance DnT,w + Ctr	54dB
Impact Sound Performance LnT,W	48dB
Impact Noise Improvement ΔLw	28dB



Concrete In-situ Floor CIS

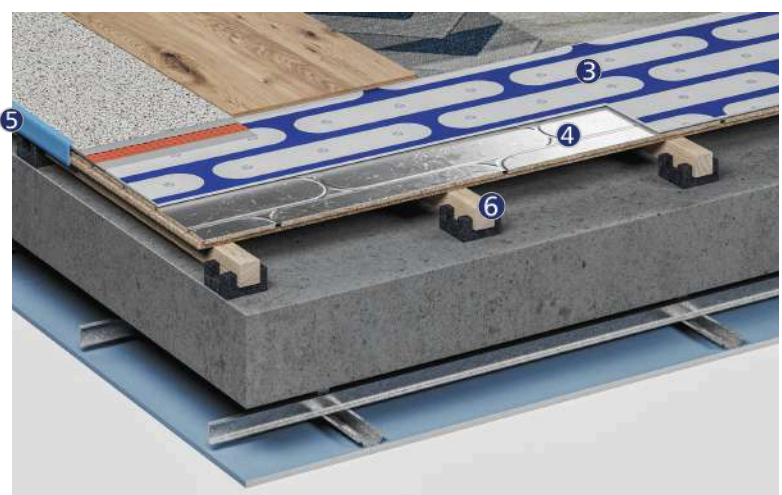

1. Ceramic Tiles / Timber flooring / Carpet / Vinyl
2. Adhesive or decoupling layer
3. Resonate ResoBACKER cement fibre cover boards
4. Resonate ResoThermchip
5. ResoThermEdge flanking strip
6. ResoCradle's and timber battens
7. 200mm Reinforced in-situ concrete slab
8. MF Ceiling (min 100mm void)
9. 1 x 9.5mm acoustic plasterboard

Airborne Sound Performance DnT,w + Ctr	54dB
Impact Sound Performance LnT,W	48dB
Impact Noise Improvement ΔLw	28dB





Product Applications and Typical Acoustic Performances

Concrete Block Beam Floor **BB**



1. Ceramic Tiles / Timber flooring / Carpet / Vinyl
2. Adhesive or decoupling layer
3. Resonate GYPDECK Structural floor panel
4. ResoThermEdge flanking strip
5. ResoCradle's and timber battens
6. Concrete block beam
7. MF Ceiling (min 100mm void)
8. 1 x 9.5mm acoustic plasterboard

Airborne Sound Performance $DnT,w + Ctr$	51dB
Impact Sound Performance LnT,W	47dB
Impact Noise Improvement ΔLw	28dB



Concrete Block Beam Floor **BB**

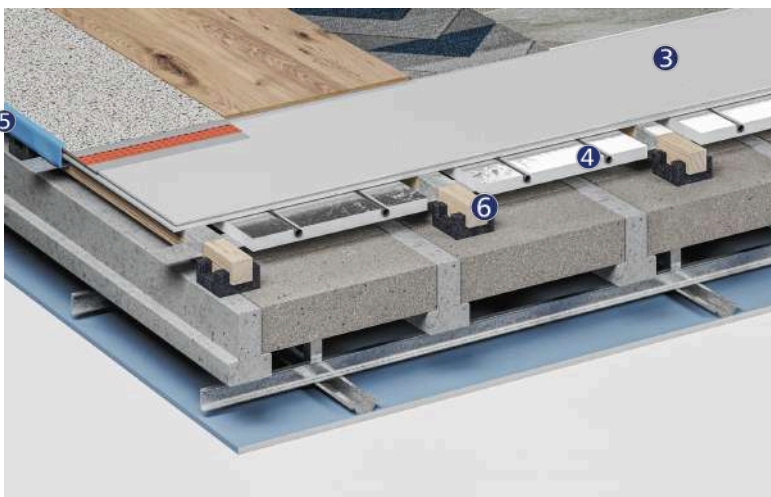

1. Ceramic Tiles / Timber flooring / Carpet / Vinyl
2. Adhesive or decoupling layer
3. Resonate GYPDECK Structural floor panel
4. UFH pipes laid in ResoThermXPS insulation
5. ResoThermEdge flanking strip
6. ResoCradle's and timber battens
7. Concrete block beam
8. MF Ceiling (min 100mm void)
9. 1 x 9.5mm acoustic plasterboard

Airborne Sound Performance $DnT,w + Ctr$	51dB
Impact Sound Performance LnT,W	47dB
Impact Noise Improvement ΔLw	28dB



Concrete Block Beam Floor **BB**

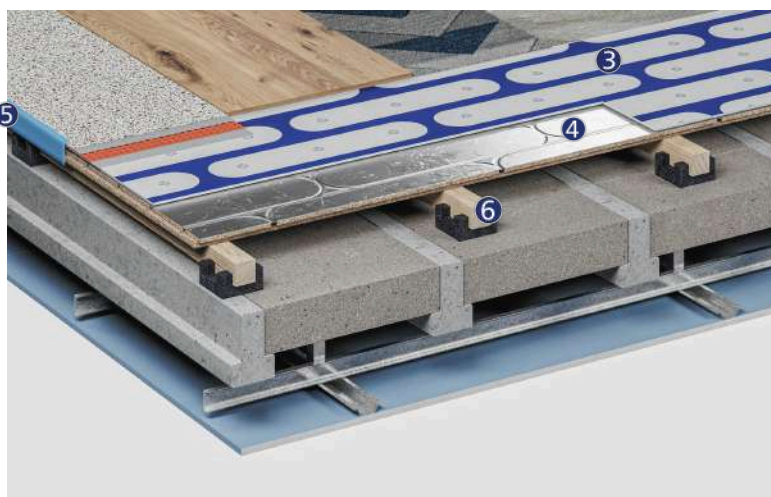

1. Ceramic Tiles / Timber flooring / Carpet / Vinyl
2. Adhesive or decoupling layer
3. Resonate ResoBACKER cement fibre cover boards
4. Resonate ResoThermchip
5. ResoThermEdge flanking strip
6. ResoCradle's and timber battens
7. Concrete block beam
8. MF Ceiling (min 100mm void)
9. 1 x 9.5mm acoustic plasterboard

Airborne Sound Performance $DnT,w + Ctr$	51dB
Impact Sound Performance LnT,W	47dB
Impact Noise Improvement ΔLw	28dB





Product Applications and Typical Acoustic Performances

Profiled Metal Deck Floor

MD



1. Ceramic Tiles / Timber flooring / Carpet / Vinyl
2. Adhesive or decoupling layer
3. Resonate GYPDECK Structural floor panel
4. ResoThermEdge flanking strip
5. ResoCradle's and timber battens
6. 130mm concrete on profiled metal deck
7. MF Ceiling (min 100mm void)
8. 1 x 9.5mm acoustic plasterboard

Airborne Sound Performance DnT,w + Ctr	55dB
Impact Sound Performance LnT,W	47dB



Profiled Metal Deck Floor

MD

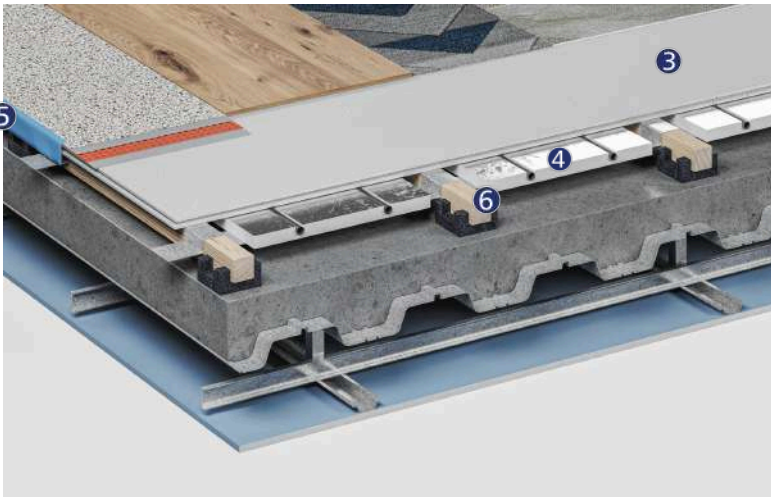

1. Ceramic Tiles / Timber flooring / Carpet / Vinyl
2. Adhesive or decoupling layer
3. Resonate GYPDECK Structural floor panel
4. UFH pipes laid in ResoThermXPS insulation
5. ResoThermEdge flanking strip
6. ResoCradle's and timber battens
7. 130mm concrete on profiled metal deck
8. MF Ceiling (min 100mm void)
9. 1 x 9.5mm acoustic plasterboard

Airborne Sound Performance DnT,w + Ctr	55dB
Impact Sound Performance LnT,W	47dB



Profiled Metal Deck Floor

MD

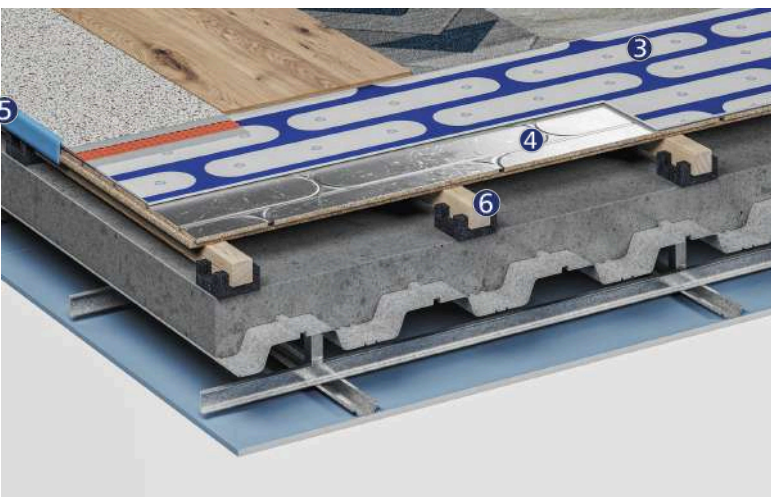

1. Ceramic Tiles / Timber flooring / Carpet / Vinyl
2. Adhesive or decoupling layer
3. Resonate ResoBACKER cement fibre cover boards
4. Resonate ResoThermchip insulation
5. ResoThermEdge flanking strip
6. ResoCradle's and timber battens
8. 130mm concrete on profiled metal deck
9. MF Ceiling (min 100mm void)
10. 1 x 9.5mm acoustic plasterboard

Airborne Sound Performance DnT,w + Ctr	55dB
Impact Sound Performance LnT,W	47dB



Performance figures shown are for indicative purposes only. For technical advice specific to your project please contact Resonate Systems technical team.



Product Applications and Typical Acoustic Performances

Pre-Cast Concrete Floor PCC



1. Ceramic Tiles / Timber flooring / Carpet / Vinyl
2. Adhesive or decoupling layer
3. Resonate GYPDECK Structural floor panel
4. ResoThermEdge flanking strip
5. ResoCradle's and timber battens
6. 150mm Pre - cast concrete slab
7. MF ceiling (min 100mm void)
8. 1 x 9.5mm acoustic plasterboard

Airborne Sound Performance DnT,w + Ctr	54dB
Impact Sound Performance LnT,W	49dB



Pre-Cast Concrete Floor PCC

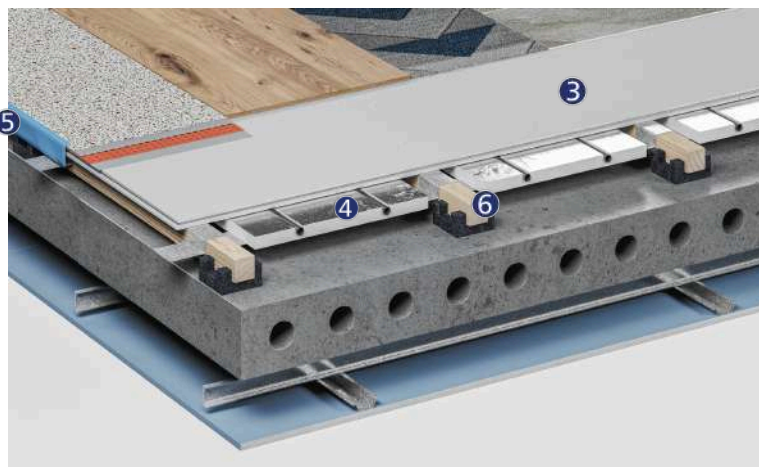

1. Ceramic Tiles / Timber flooring / Carpet / Vinyl
2. Adhesive or decoupling layer
3. Resonate GYPDECK Structural
4. UFH pipes laid in ResoThermXPS
5. ResoThermEdge flanking strip
6. ResoCradle's and timber battens
7. 150mm Pre - cast concrete slab
8. MF ceiling (min 100mm void)
9. 1 x 9.5mm acoustic plasterboard

Airborne Sound Performance DnT,w + Ctr	54dB
Impact Sound Performance LnT,W	49dB



Pre-Cast Concrete Floor PCC



1. Ceramic Tiles / Timber flooring / Carpet / Vinyl
2. Adhesive or decoupling layer
3. Resonate ResoBACKER cement fibre cover board
4. Resonate ResoThermchip
5. ResoThermEdge flanking strip
6. ResoCradle's and timber battens
7. 150mm Pre - cast concrete slab
8. MF ceiling (min 100mm void)
9. 1 x 9.5mm acoustic plasterboard

Airborne Sound Performance DnT,w + Ctr	54dB
Impact Sound Performance LnT,W	49dB



Performance figures shown are for indicative purposes only. For technical advice specific to your project please contact Resonate Systems technical team.