

ResoWall 30



Product Information & Technical Data Sheet

Resonate ResoWall 30 is a high performance acoustic wall lining board. The boards are suitable for both timber stud and concrete block walls in new build and refurbishment developments.

Slimline Wall Soundproofing

At just 30mm thickness, ResoWall 30 wall boards represent a slim, space saving solution for wall soundproofing. This provides a significant benefit against alternative solutions that require separate wall linings.

For maximum soundproofing benefits the boards should be fixed to resilient bars, or can be installed directly to the wall if space is at a premium.

The composition of ResoWall 30 consists of a 15mm paper faced HD plasterboard, technically bonded to high performance 15mm wood fibre absorption board. Available in square or tapered edge.

Key Benefits

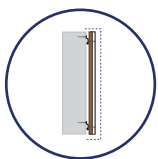

- ✓ Low space impact on existing wall (30mm/46mm)

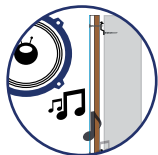

- ✓ High performance airborne noise reduction



- ✓ Paper face, for easy plaster finish



- ✓ Robust absorption backing, will not compress under loading

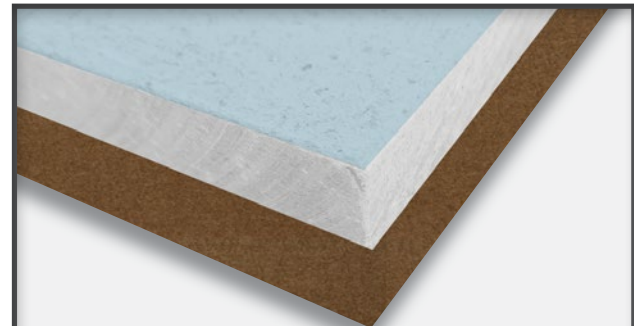

System Components

1. Resonate ResoWall 30 acoustic wall lining

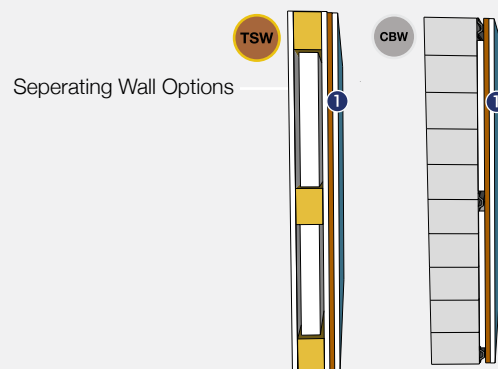

Dimensions

Board Dimensions	1200mm (W) 2400mm (L) 30mm (Thickness)
Board m²	2.88m ² per board
Boards Per Pallet	30 Boards / 86.4m ²
Board Weight	14.90 kg/m ² 43 kg per batten
Pallet Dimensions	2400mm (w) 1200mm (L) 1050mm (H)
Pallet Weight	1325 kg

Product Applications and Typical Acoustic Performances

Timber Stud Wall TSW



1. Timber stud partition
2. **ResoWall 30**
3. **ResoBar 16** resilient bars installed on wall
4. **ResoQuilt 15** in-between **ResoBar 16**
5. **ResoQuilt 50** in-between partition

Airborne Sound Performance Rw	55dB
Rw + Ctr	48dB

Fixed to resilient bar on timber or metal stud partition



1. Timber stud partition
2. **ResoWall 30**
3. **ResoQuilt 50** in-between partition

Airborne Sound Performance Rw	51dB
Rw + Ctr	44dB

Directly fixed to timber or metal stud partition

Concrete Block Wall CBW



1. Masonry Wall
2. **ResoWall 30**
3. **ResoBar 16** resilient bars installed on wall
4. **ResoQuilt 15** in-between **ResoBar 16**

Airborne Sound Performance Rw	54dB
Rw + Ctr	47dB

Fixed to resilient bar on existing masonry wall



1. Masonry Wall
2. **ResoWall 30**

Airborne Sound Performance Rw	51dB
Rw + Ctr	44dB

Directly fixed to existing masonry wall